

A Project by



PROPOSED BROCHURE



SIVANTA
GREENS
Affordable Luxury

3BHK & 4BHK
APARTMENTS

Home is where your story begins. Where you choose to live, is equally as important as what your lifestyle will be when you are living there.

Sivanta Greens is situated in the picturesque foothills of majestic Shivalik range located advantageously in the heart of Mohali, Sector 85.

Sivanta Greens presents a life that has been built on these fundamentals.

Location, one that surrounds you with lifestyle, shopping and F&B establishments. Connections, with a transport network that takes you anywhere you need to be in minutes. Education, because the pursuit of learning at any age should never be undervalued. Architecture, in creating a home that stands the test of time and draws inspiration from the gardens outside, to create a life that's well-lived inside.

A home is more than just a roof over our head.

It's a place to grow lifetime of memories. Sivanta Greens is a breath of fresh air where growth and wellness are integrated to create an energised, holistic environment for you and your loved ones.

There is no better investment than in your family or yourself,

and no better place to put down your roots.





















*Inspired by the gardens.
designed for your
wellness and wellbeing*



Residents' Facilities within campus

-  RERA certified project
-  Only gated Township in Mohali
-  Direct road connectivity from Chandigarh
-  Families already residing
-  24*7 power backup on floors
-  Operational Club House

Elite Club House Amenities:

-  GYM, Yoga & Aerobics room
-  Library
-  Carrom and cards room
-  Kids play zone
-  Home theatre
-  Swimming pool
-  Multi-purpose recreational hall
-  Facilities for Pool & Table Tennis
-  Lifts
-  Parking Facilities



TECHNICAL SPECIFICATIONS



LIVING/DINING ROOM

Flooring / Skirting: Glazed Vitrified Tiles
Wall Finish: Plaster Superior Plastic Emulsion Paint
Ceiling: False ceiling in Drawing Dining Room



MODULAR KITCHEN

Flooring / Skirting: Glazed Vitrified Tiles
Wall Finish: Designer Glazed Ceramic Tiles and Superior Plastic Emulsion Paint
Counter: Granite Stone & Modular Kitchen



BED ROOMS

Flooring / Skirting: Glazed Vitrified Tiles Wall
Finish: Plaster, Superior Plastic Emulsion Paint
Ceiling: False Ceiling
Wood Work: Wooden Wardrobes



WOODEN DOORS AND WINDOW

Internal Door: Wooden Laminated/ Veneer Doors
Outer Doors & Windows: UPVC



TOILETS

Flooring / Skirting: Anti-Skid Ceramic Tiles
Wall Finish: Designer Glazed Ceramic Tiles
Fitting: Kohler /Jaquar or equivalent C.P. Sanitary Fittings



BALCONY

Flooring / Skirting: Anti-Skid Ceramic Tiles Wall
Finish: Plaster & Weather Proof Exterior Paint
Railing: MS/SS Railing

ELECTRICAL



Cables, Switches & Sockets of Good Brands, Necessary Points for AC, Geyser etc.

STAIR CASE

Flooring/Skirting: Anti-Skid Ceramic Tiles/ Marble / Granite
Railing: MS/SS Railing

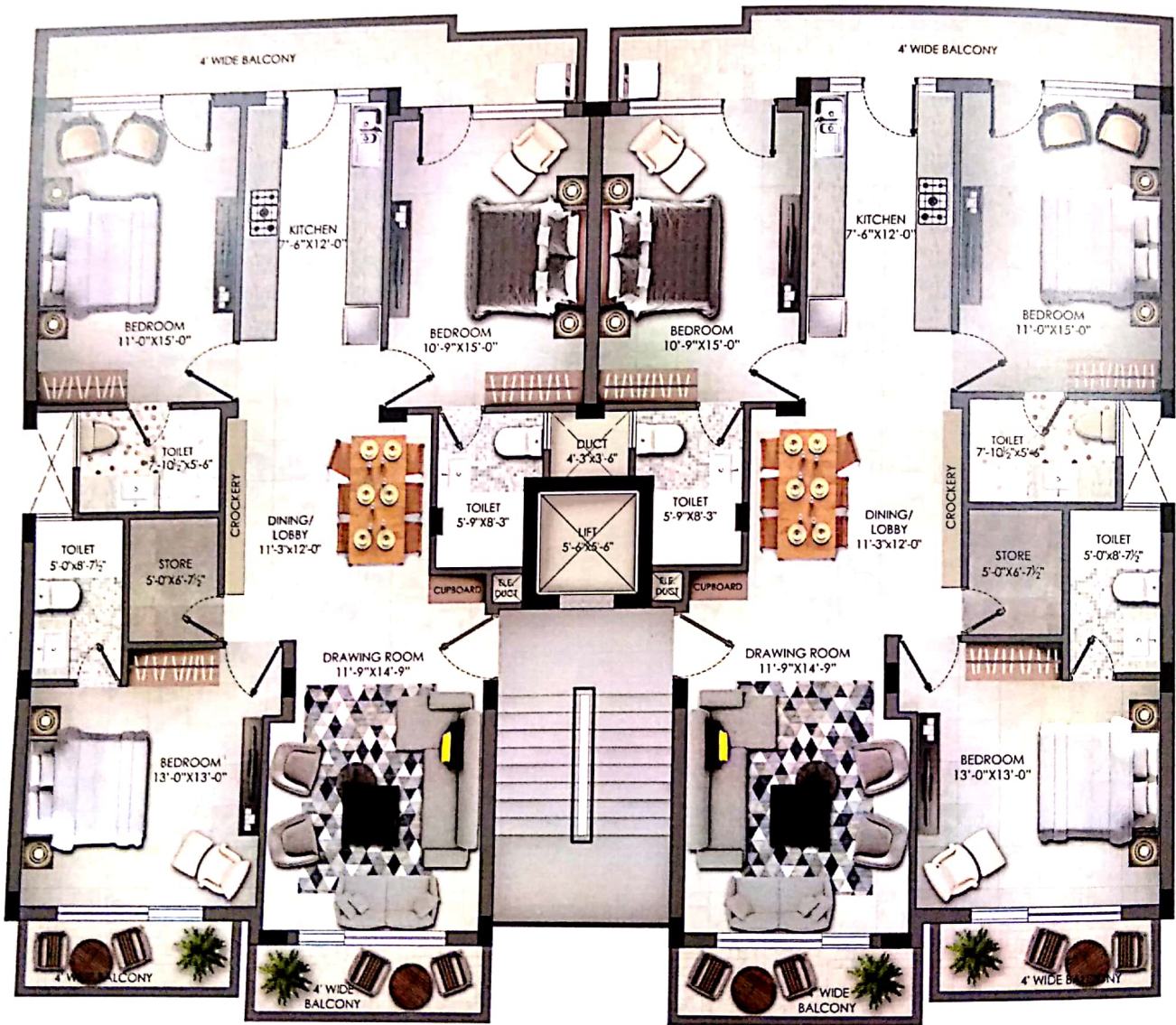

3 BEDROOM - TYPICAL FLOOR PLAN

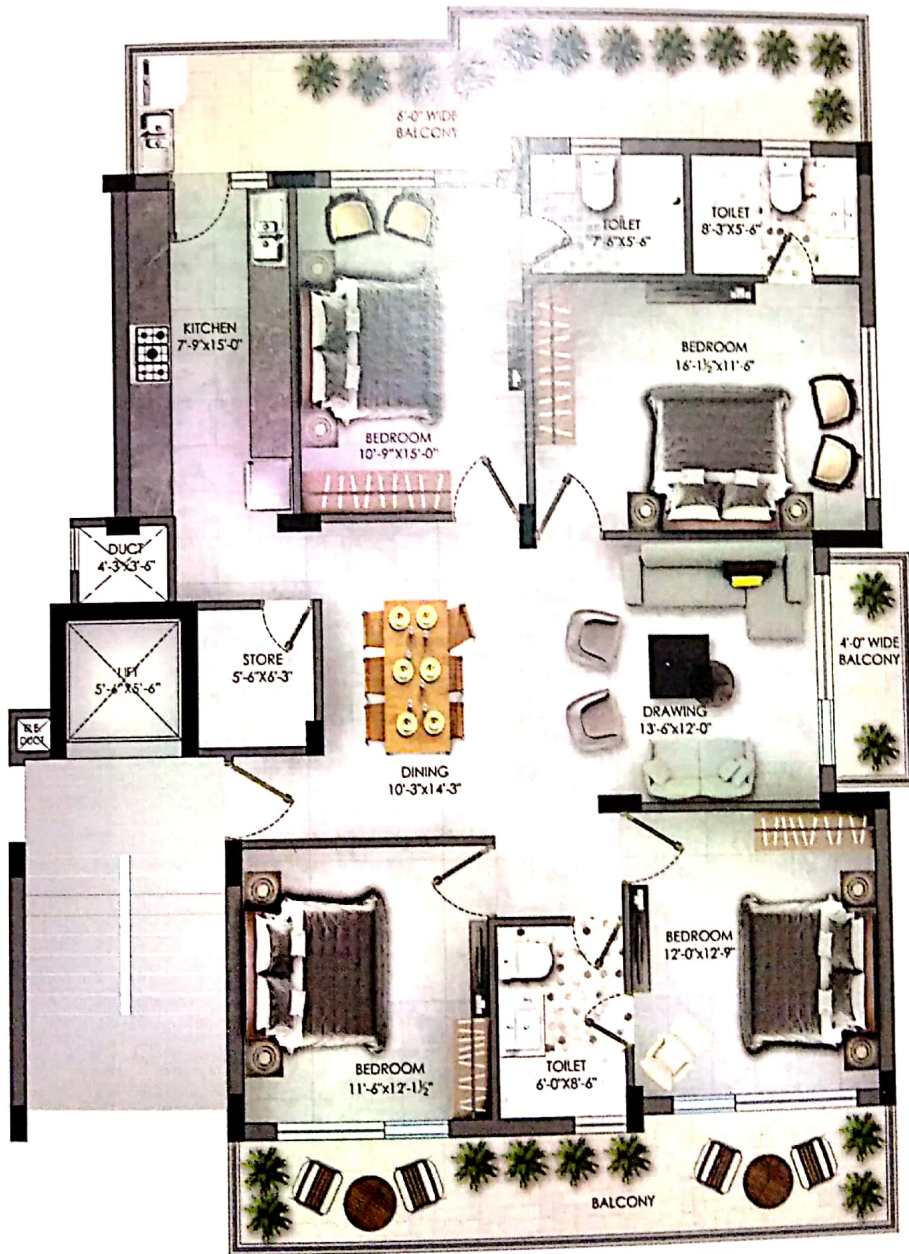

4 BEDROOM - TYPICAL FLOOR PLAN



Site Office:

Sivanta Greens, Wave Estate, Block B, Sector 85, Mohali, 140308

Contact Us:

90666-77000, 90666-33000

This document is for internal calculation only.